



TUBA OPAL
surface

- 4265
- 4279WW
- 4266
- 4280WW
- 4267
- 4281WW
- 4268
- 4282WW
- 4290
- 4295WW
- 4291
- 4296WW

TUBA OPAL
suspension

TUBA opal

1. MAKE DENTS ON THE WALL / CEILING BY TAPPING THE LAMP.
2. DRILL THE HOLES FOR THE PLUGS.
3. PULL BOTH CAPS, INSERT BULB AND CLIP IT TO THE BASE.
4. MAKE THE ELECTRICAL CONNECTION TO THE CONNECTION BOX (TABLE 1)

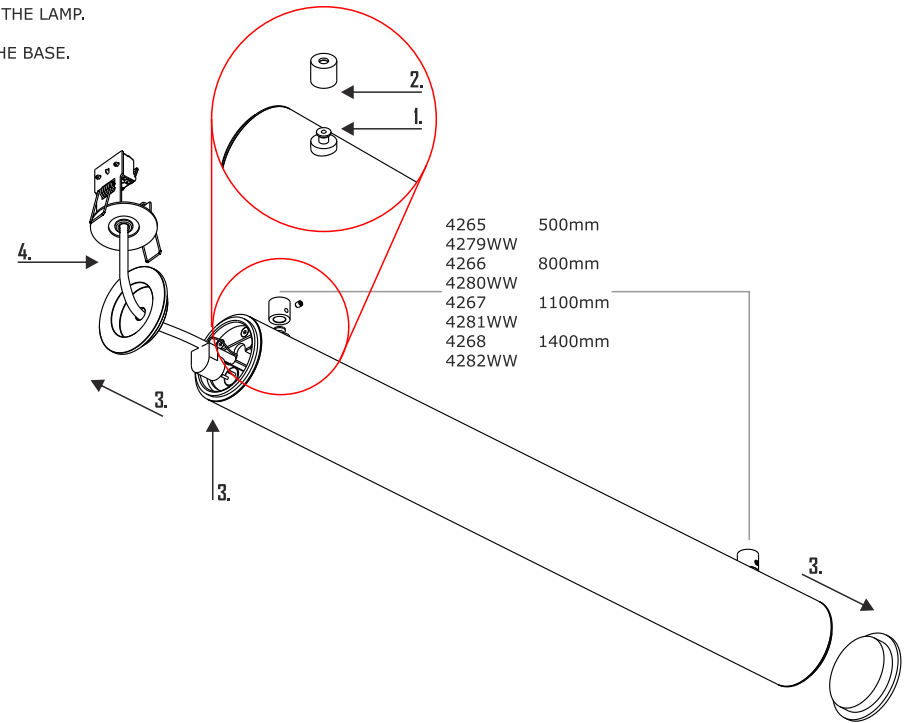
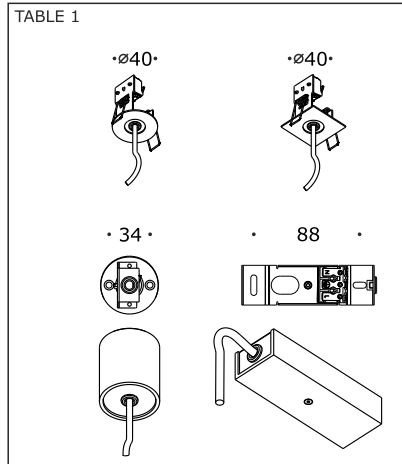

1515 / 1215

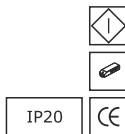
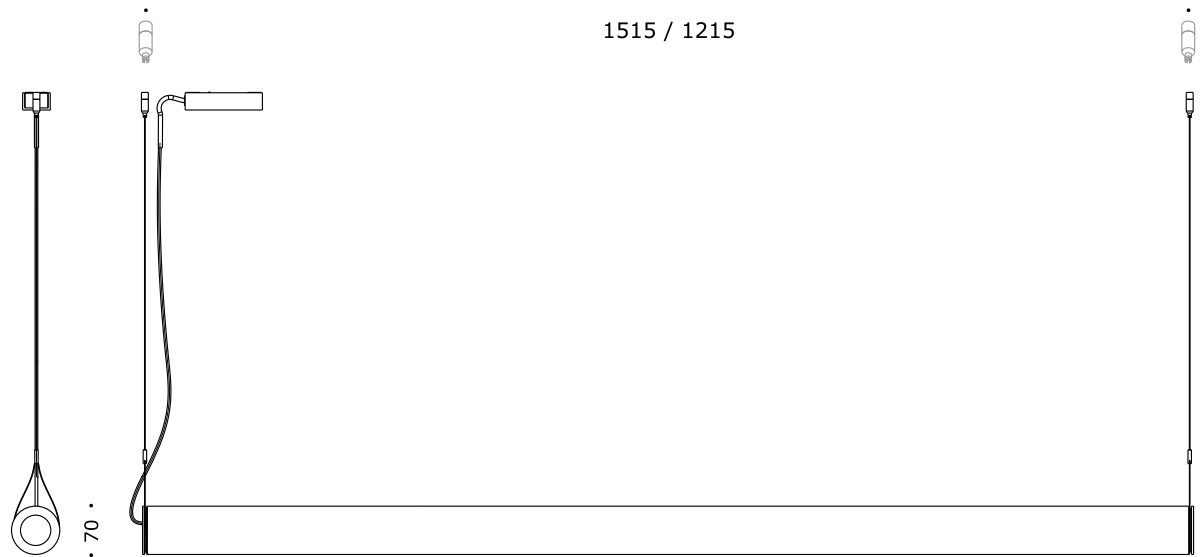

DEKKO

12-16 DRAGAN TSANKOV BLVD
1164 SOFIA,
BULGARIA

T +359 (0)2 8168116
F +359 (0)2 8168118

office@dekko.net
www.dekko.net